



# CONTACT MOTORCYCLES

## KTM 390 Adventure R

### ASSEMBLY GUIDE | PANNIER RACK

#### Tools Required

- ☐ Ratchet + Extension
- ☐ 6mm Allen Socket
- ☐ 8mm Hex Socket
- ☐ 10mm Hex Socket
- ☐ 10mm Wrench / Spanner
- ☐ Blue Loctite (recommended)

Number	QTY	Specifications	Torque (NM)
<u>1</u>	2	M8 x 50mm Allen Head	*
<u>2</u>	2	M8 x 40mm Allen Head	*
<u>3</u>	4	M8 x 35mm Allen Head	*
<u>4</u>	4	M6 x 20mm Allen Head	<b>12</b>
<u>5</u>	8	M8 Washer	-
<u>6</u>	8	M6 Washer	-
<u>7</u>	4	M6 Nyloc Nut	-
<u>8</u>	2	Foot Peg Spacer	-
<u>9</u>	2	10.5mm Spacer	-
<u>10</u>	2	30mm Spacer	-

\* PLEASE REFER TO THE OWNER'S (OR SERVICE) MANUAL FOR **OEM** TORQUE SPECIFICATIONS.\*

STEP 1 (Left Side) :

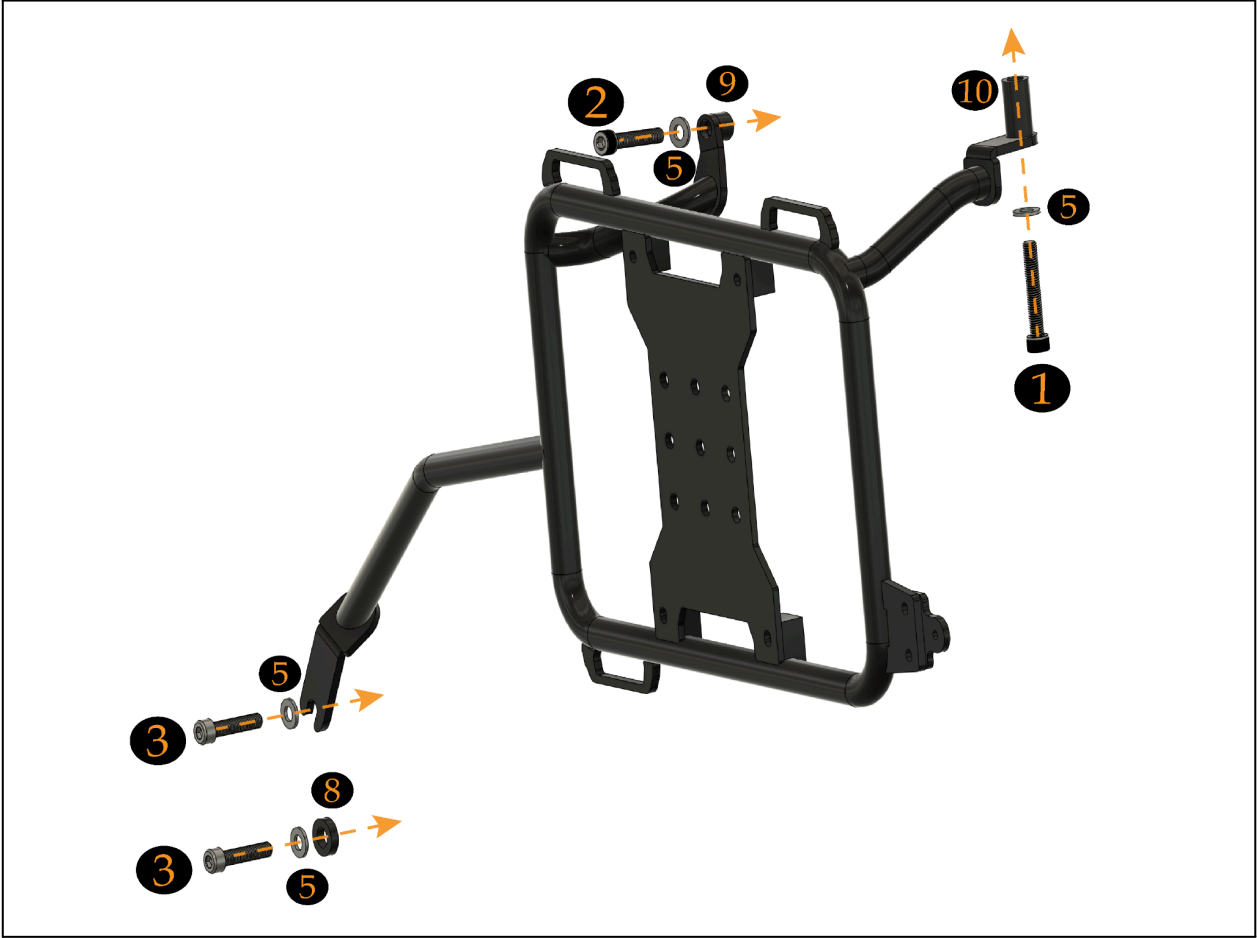

STEP 2 (Right Side - Identical) :

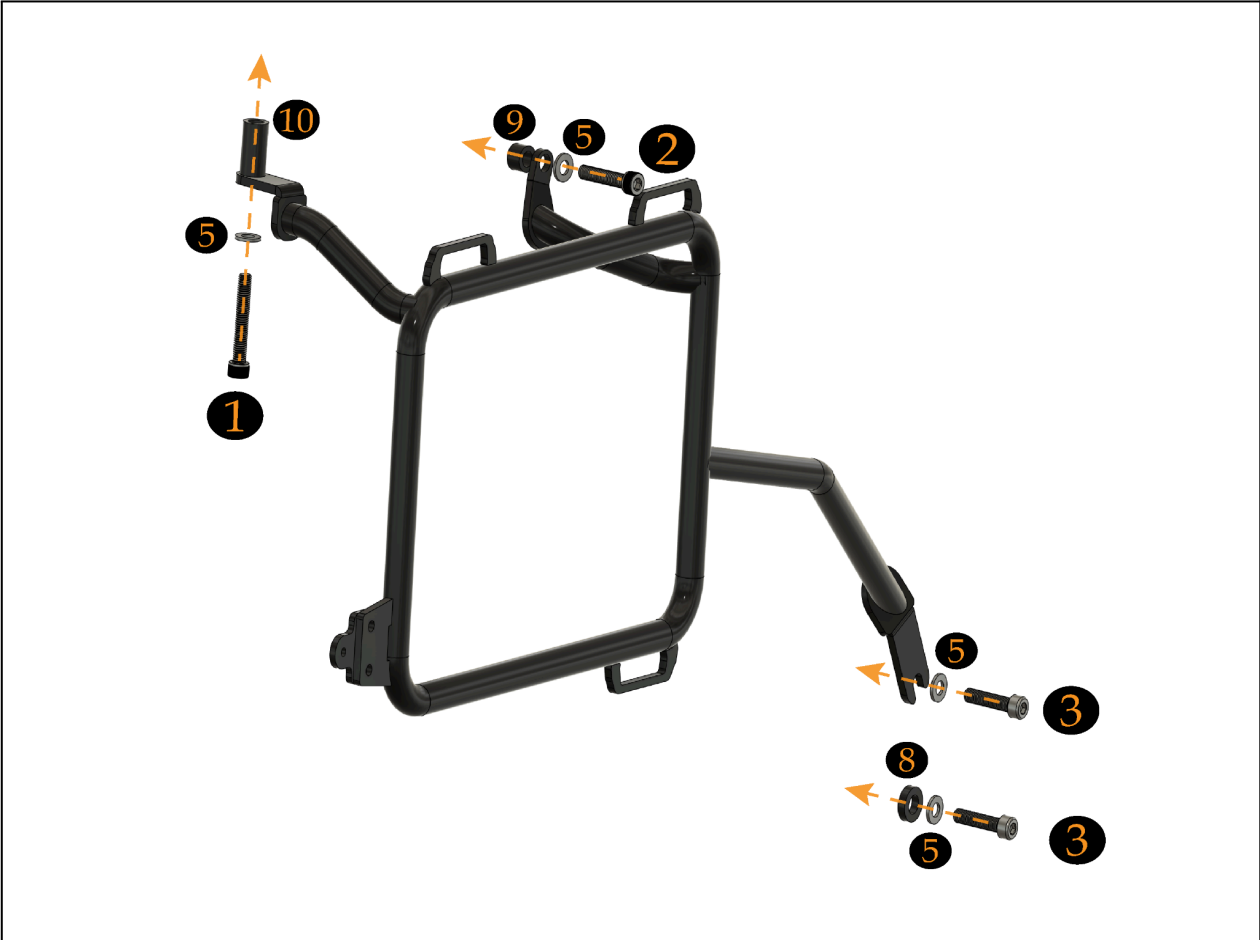

### STEP 3:

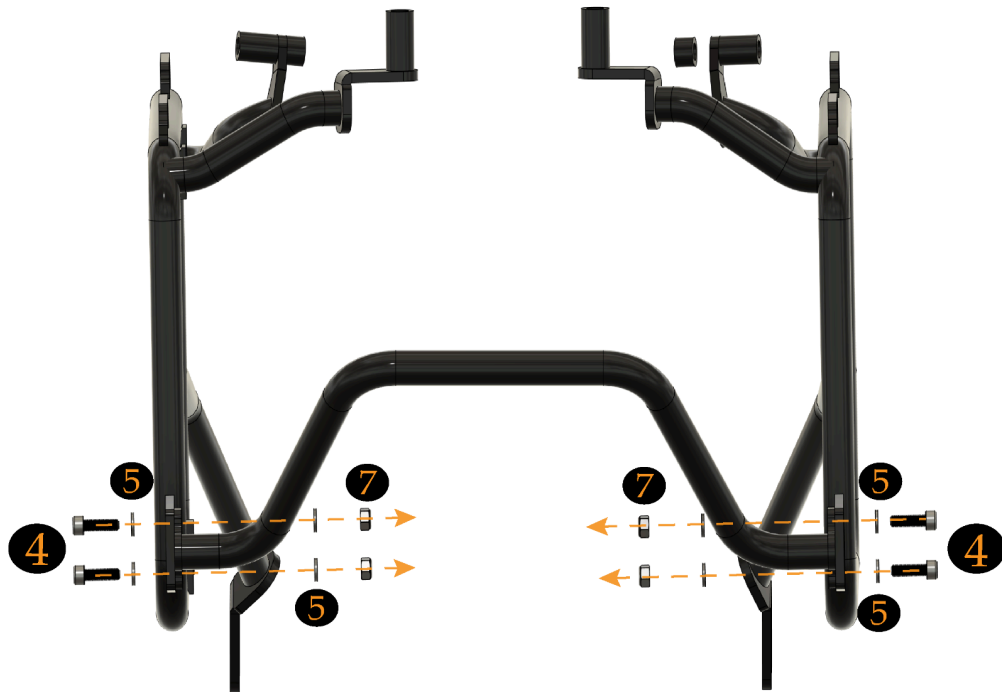

#### **\* Torque Disclaimer \***

Torque specs provided by Outback Motortek are for guidance only and may reference OEM data. Incorrect torque application from miscalibrated or improperly stored torque wrenches (which can drift by up to 20% within 12 months) may cause broken studs or mounting failures. Always return torque wrenches to 0 ft-lbs when storing, and use blue Loctite (medium strength) on all fasteners to help prevent loosening. Outback Motortek is not responsible for damage or failures caused by mis-torquing or improper installation.