



**CUTECRUIZ
MOTORCYCLES**

KTM 390 Adventure R

ASSEMBLY GUIDE | **SKID PLATE**

Tools Required

- ☐ Ratchet + Extension
- ☐ 13mm Hex Socket
- ☐ 10mm Hex Socket
- ☐ 8mm Allen Socket
- ☐ 5mm Allen Socket
- ☐ Blue Loctite (recommended)

Number	QTY	Specifications	Torque (NM)
<u>1</u>	1	M10 x 260mm Allen Partially Threaded	*
<u>2</u>	1	OEM M8 Bolt	*
<u>3</u>	8	M8 x 25mm Counter Sunk Allen Head	23
<u>4</u>	2	M10 Washer	-
<u>5</u>	1	M10 Nyloc Nut	-
<u>6</u>	8	M8 Washer	-
<u>7</u>	8	M8 Nyloc Nut	-
<u>8</u>	2	10mm Spacer	-

* PLEASE REFER TO THE OWNER'S (OR SERVICE) MANUAL FOR **OEM** TORQUE SPECIFICATIONS.*

STEP 1 (Left Side) :

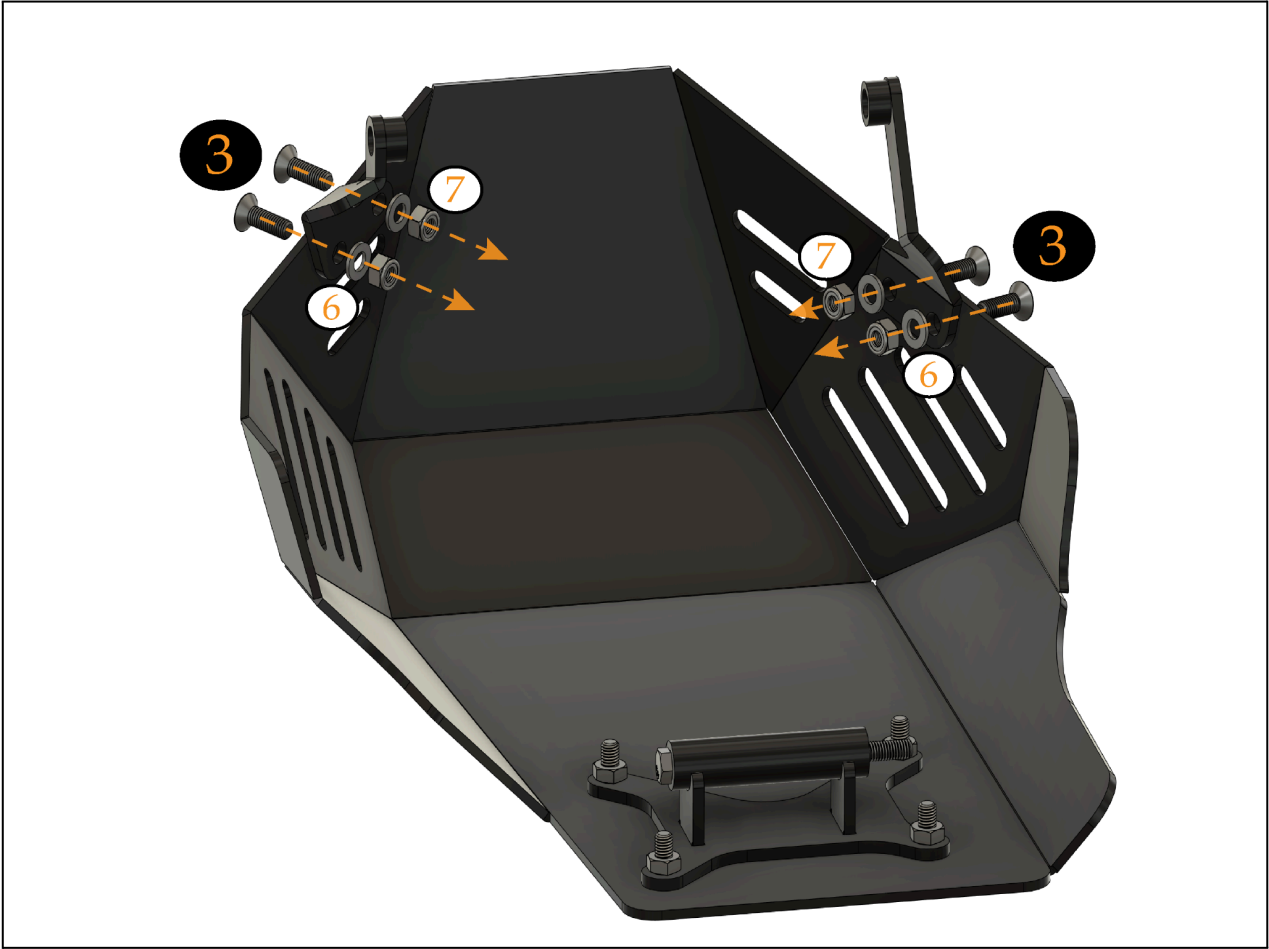

STEP 2 :

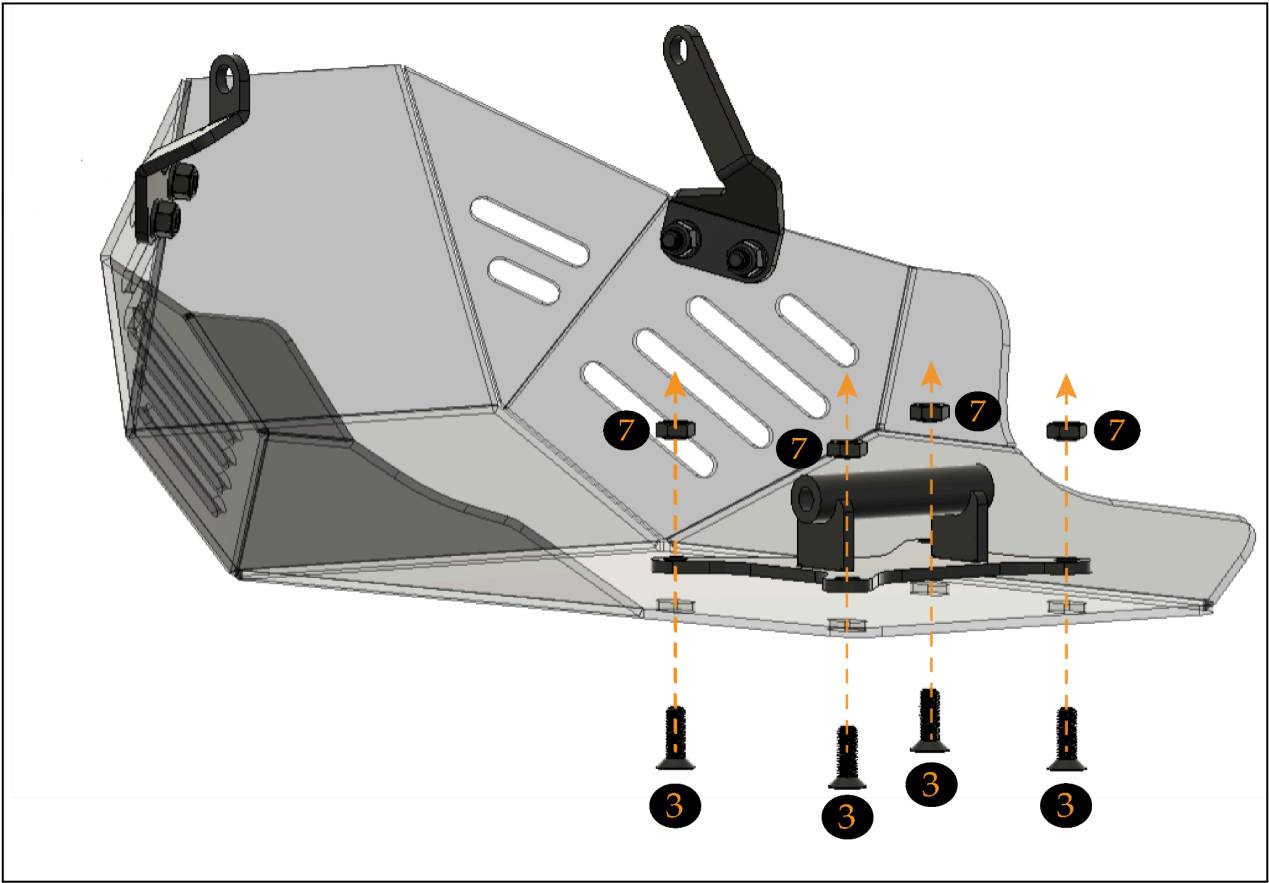

STEP 3:

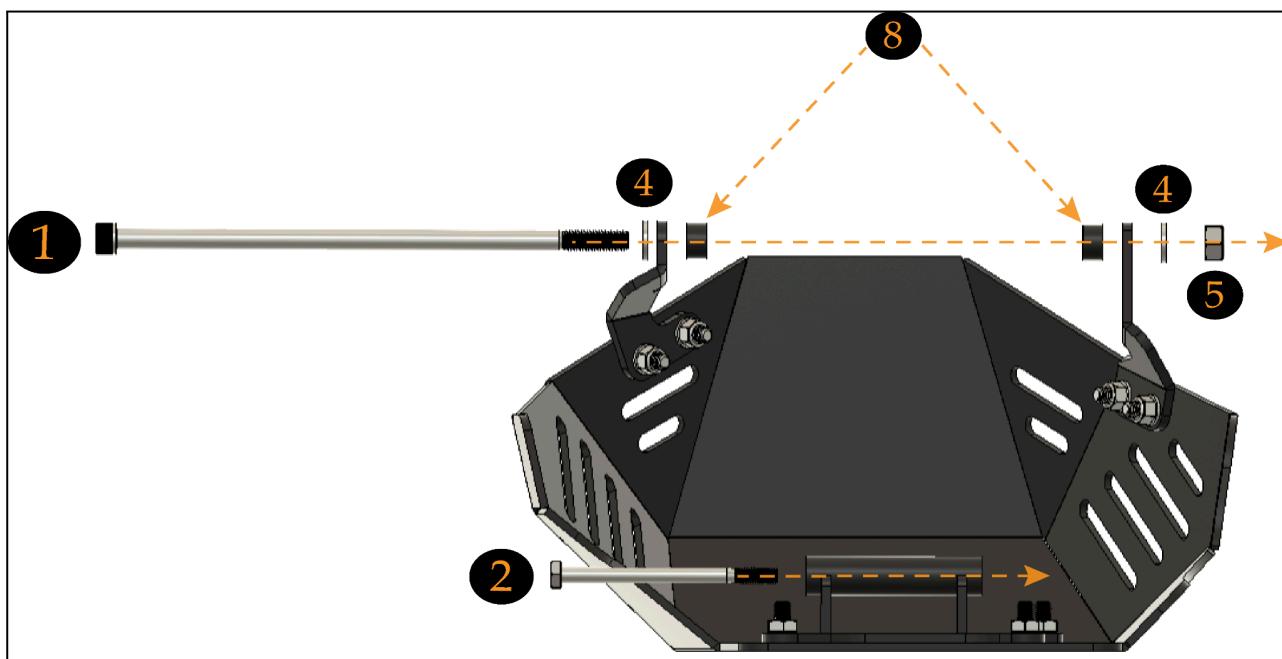

* Torque Disclaimer *

Torque specs provided by Outback Motortek are for guidance only and may reference OEM data. Incorrect torque application from miscalibrated or improperly stored torque wrenches (which can drift by up to 20% within 12 months) may cause broken studs or mounting failures. Always return torque wrenches to 0 ft-lbs when storing, and use blue Loctite (medium strength) on all fasteners to help prevent loosening. Outback Motortek is not responsible for damage or failures caused by mis-torquing or improper installation.